



Ruthven

Conference Room Layouts & Locations

Conference Rooms



Lower Level Floor Reference Plan:

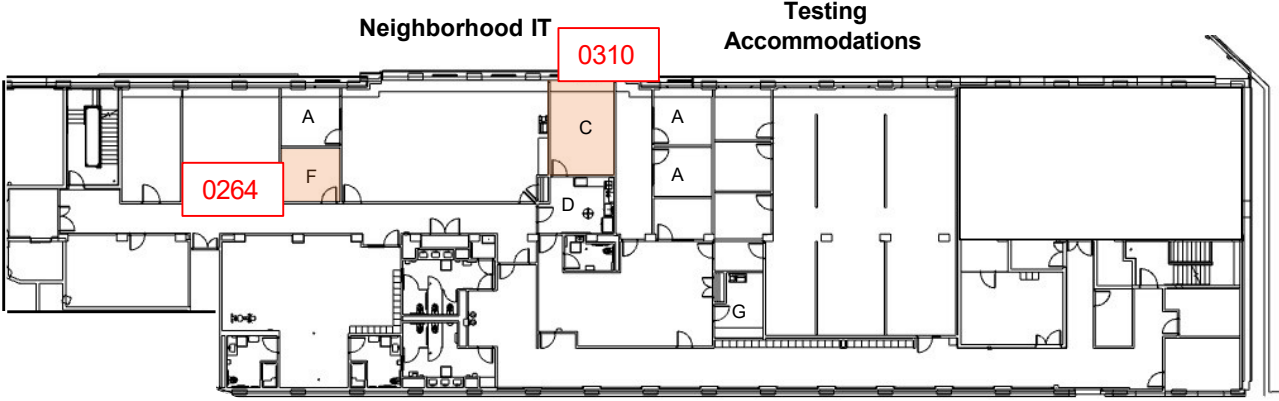

- A. Office A (3)
- B. Office B (0)
- C. Conference Room (1)
- D. Staff Kitchenette (1)
- E. Executive Office (0)
- F. Focus Room (1)
- G. Work Room (1)
- H. Commons (0)
- I. Personal Room (0)

 Schedulable Conference Room

RUTHVEN-0264 (No Table) (Capacity 4)

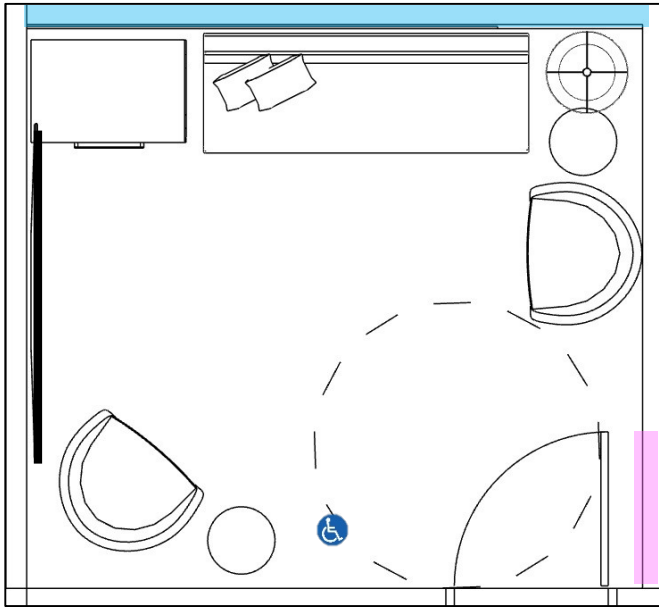

- Acoustic Panels
- Marker Board
- Coat Hooks
- Wheelchair Accessible



View from the South Wall

RUTHVEN-0310 (Table 8) (Capacity 8)

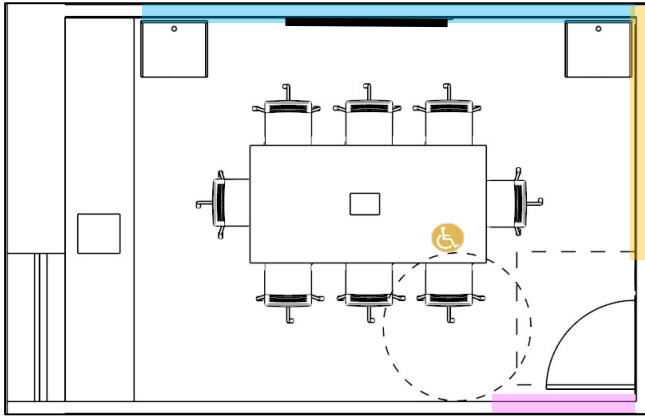

- Acoustic Panels
- Marker Board
- Coat Hooks
- Wheelchair Accessible when chairs moved out of the dashed circle / box



View from the West Wall

*Conference chairs will be ordered with fixed arms



Conference Rooms



1st Floor Reference Plan:



- A. Office A (14)
- B. Office B (8)
- C. Conference Room (6)
- D. Staff Kitchenette (1)
- E. Executive Office (2)
- F. Focus Room (3)
- G. Work Room (2)
- H. Commons (0)
- I. Personal Room (1)

Schedulable Conference Room

RUTHVEN-1100 (Table 16) (Capacity 20)

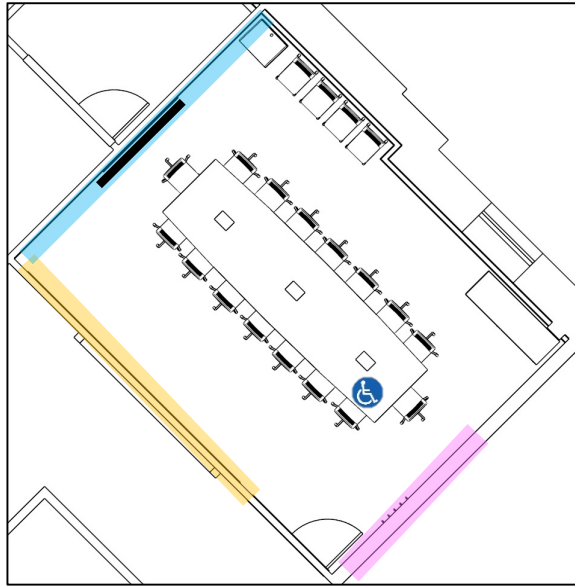

- Acoustic Panels
- Marker Board
- Coat Hooks
- Wheelchair Accessible



View from the Northwest Wall

*Conference chairs will be ordered with fixed arms



RUTHVEN-1140 (Table 16) (Capacity 22)

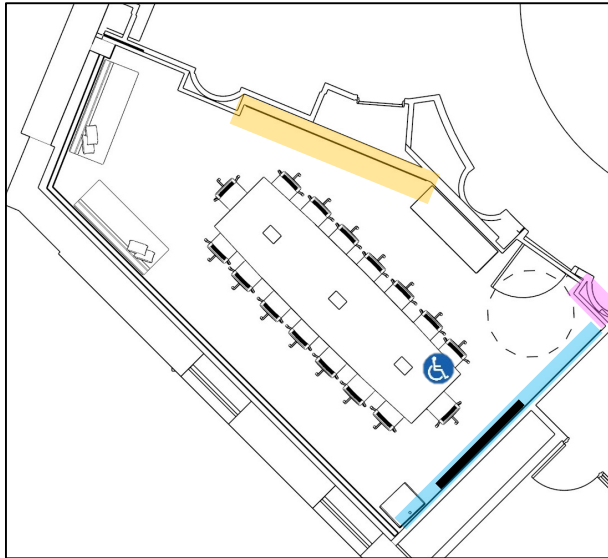

- Acoustic Panels
- Marker Board
- Coat Hooks
- Wheelchair Accessible







View from the Northwest Wall

*Conference chairs will be ordered with fixed arms

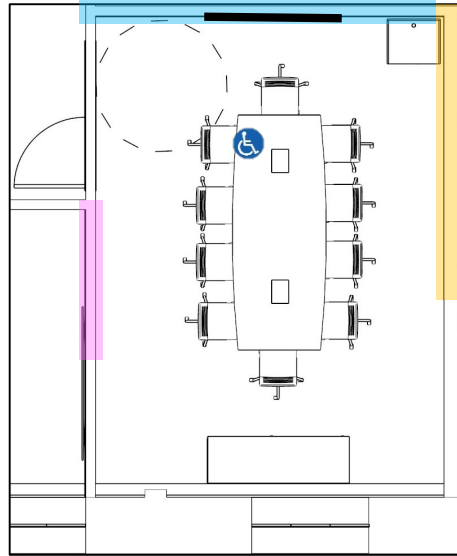

RUTHVEN-1304 (Table 10) (Capacity 10)



-  Acoustic Panels
-  Marker Board
-  Coat Hooks
-  Wheelchair Accessible







View from the North Wall

**Conference chairs will be ordered with fixed arms*

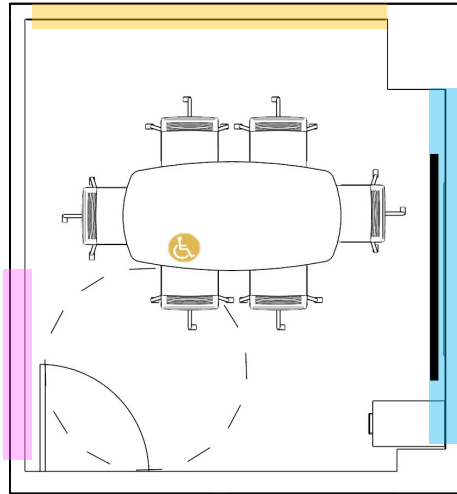

RUTHVEN-1309 (Table 6) (Capacity 6)



-  Acoustic Panels
-  Marker Board
-  Coat Hooks
-  Wheelchair Accessible when chairs moved out of the dashed circle / box



View from the East Wall

*Conference chairs will be ordered with fixed arms



RUTHVEN-1398 (Table 10) (Capacity 10)

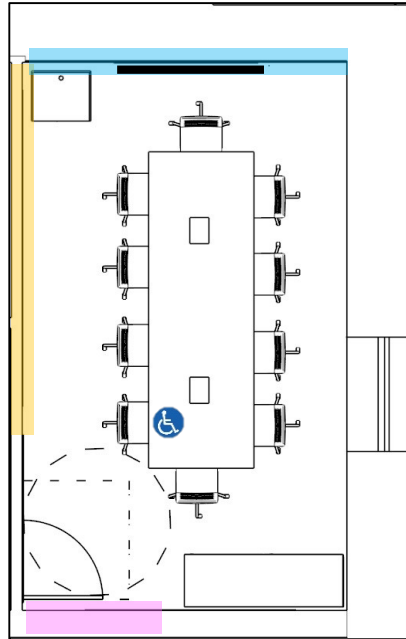

- Acoustic Panels
- Marker Board
- Coat Hooks
- Wheelchair Accessible



View from the South Wall

**Conference chairs will be ordered with fixed arms*



Conference Rooms



2nd Floor Reference Plan:

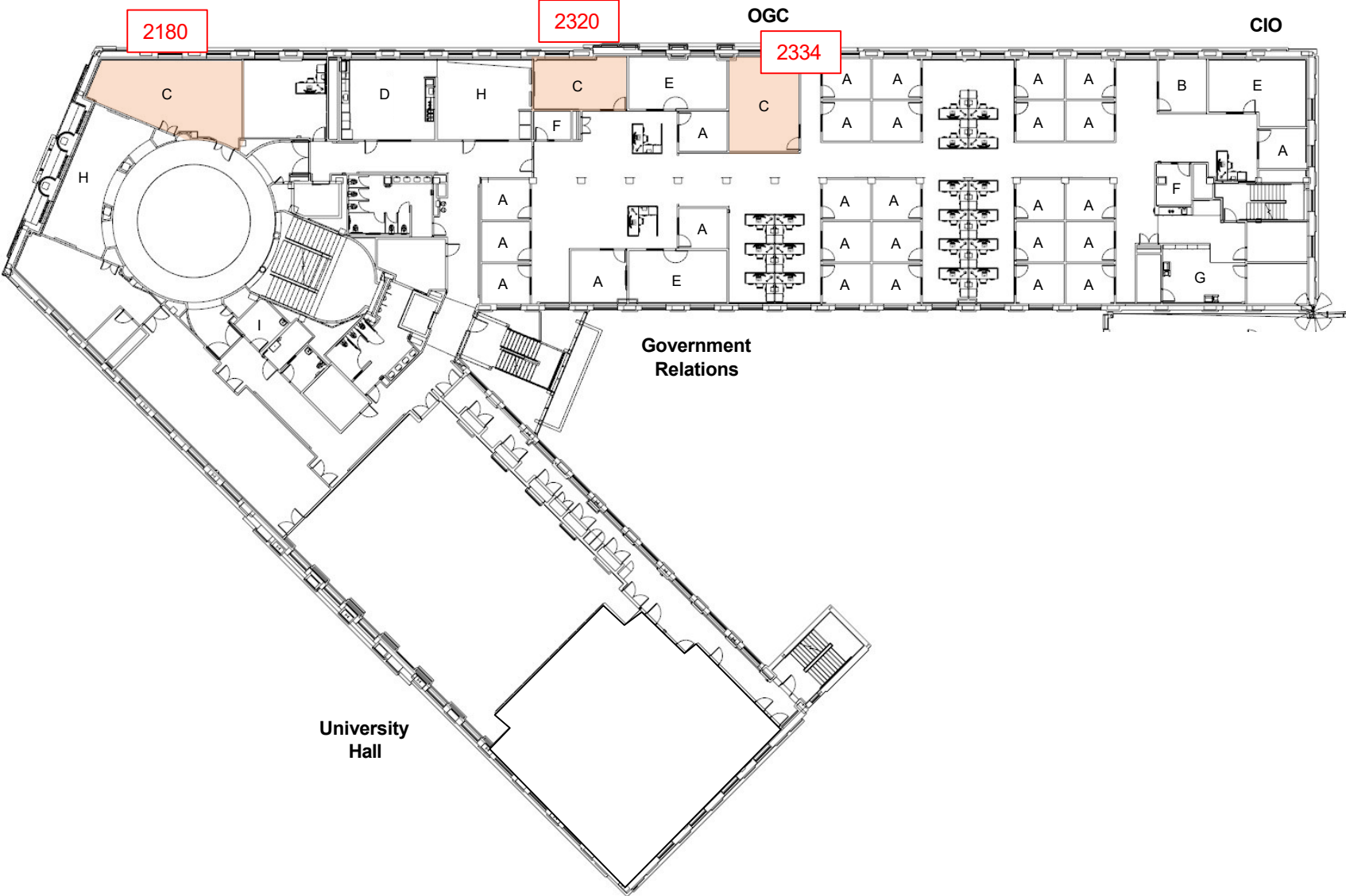

- A. Office A (26)
- B. Office B (1)
- C. Conference Room (5)
- D. Staff Kitchenette (1)
- E. Executive Office (3)
- F. Focus Room (2)
- G. Work Room (1)
- H. Commons (2)
- I. Personal Room (1)

Schedulable Conference Room

RUTHVEN-2180 (Table 20) (Capacity 37)

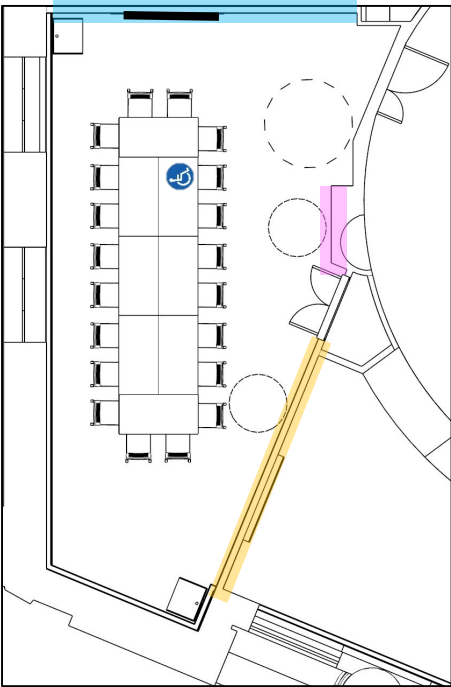

- Acoustic Panels
- Marker Board
- Coat Hooks
- Wheelchair Accessible



View from West Wall

RUTHVEN-2180 (Alternate Layouts)

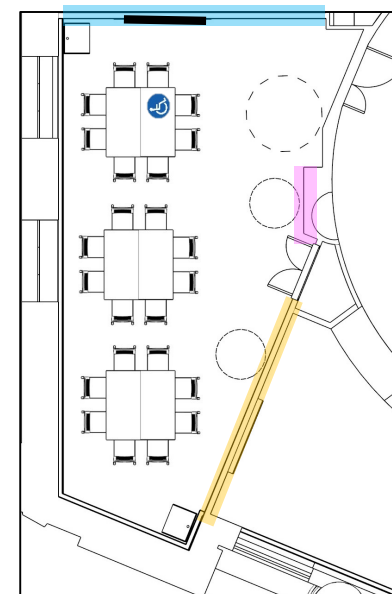
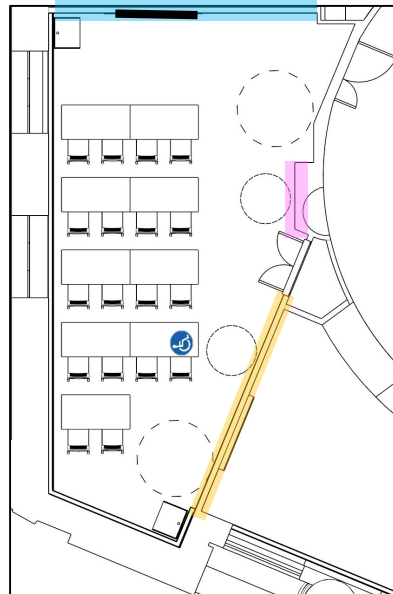
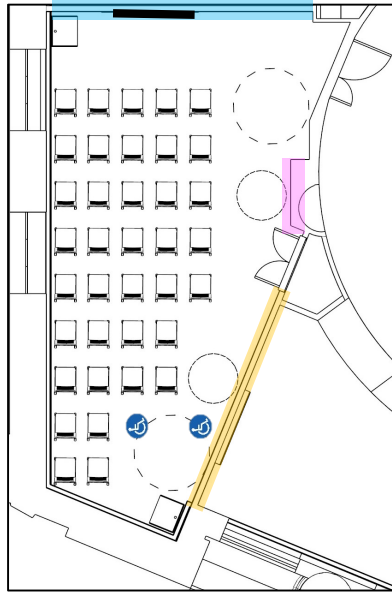

- Acous
- Marker Board
- Coat Hooks
- Wheelchair Accessible



Alternate furniture layouts may be possible, if arranged in advance with building operations. However, furniture changes may not be possible, depending on a given day's activities.

RUTHVEN-2320 (Table 12) (Capacity 12)

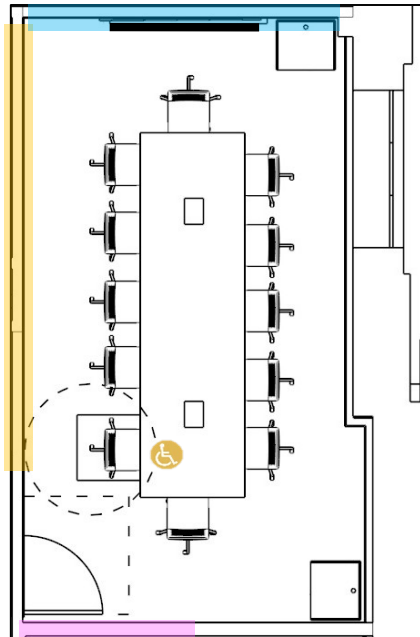

- Acoustic Panels
- Marker Board
- Coat Hooks
- Wheelchair Accessible when chairs moved out of the dashed circle / box







View from East Wall

**Conference chairs will be ordered with fixed arms*

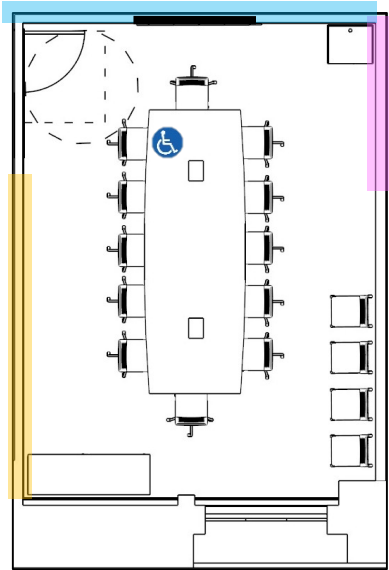

RUTHVEN-2334 (Table 12) (Capacity 16)



-  Acoustic Panels
-  Marker Board
-  Coat Hooks
-  Wheelchair Accessible



View from the North Wall

**Conference chairs will be ordered with fixed arms*

3RD FLOOR CONFERENCE ROOMS



- A. Office A (28)
- B. Office B (3)
- C. Conference Room (6)
- D. Staff Kitchenette (1)
- E. Executive Office (2)
- F. Focus Room (2)
- G. Work Room (3)
- H. Commons (1)
- I. Personal Room (0)

Schedulable Conference Room

RUTHVEN-3334 (Table 12) (Capacity 12)

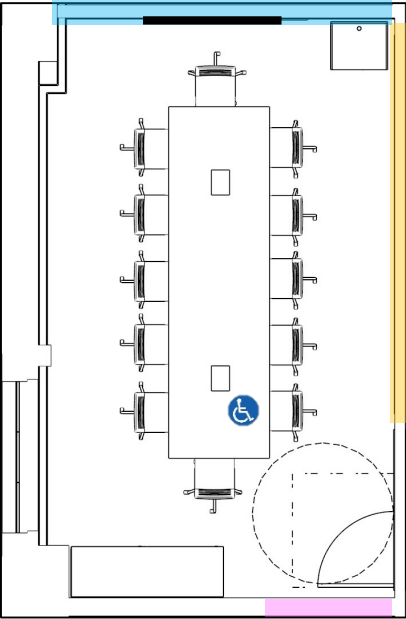

- Acoustic Panels
- Marker Board
- Coat Hooks
- Wheelchair Accessible



View from West Wall

*Conference chairs will be ordered with fixed arms



RUTHVEN-3394 (Table 8) (Capacity 8)

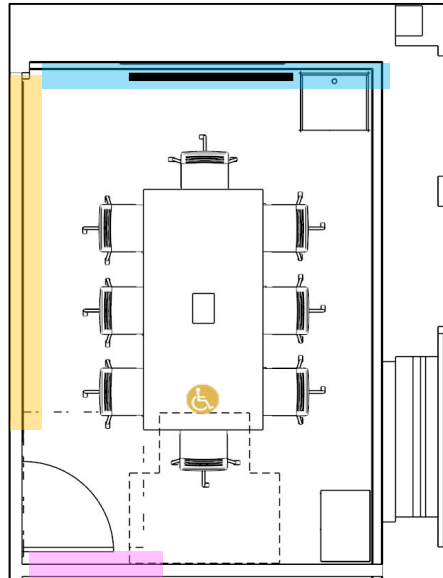

- Acoustic Panels
- Marker Board
- Coat Hooks
- Wheelchair Accessible when chairs moved out of the dashed circle / box



View from the South Wall

*Conference chairs will be ordered with fixed arms

Conference Rooms



4th Floor Reference Plan:



- A. Office A (30)
- B. Office B (16)
- C. Conference Room (8)
- D. Staff Kitchenette (1)
- E. Executive Office (2)
- F. Focus Room (4)
- G. Work Room (2)
- H. Commons (1)
- I. Personal Room (1)

Schedulable Conference Room

RUTHVEN-4110 (Table 12) (Capacity 16)



Acoustic Panels

Marker Board

Coat Hooks

Wheelchair Accessible







View from the Northwest Wall

**Conference chairs will be ordered with fixed arms*

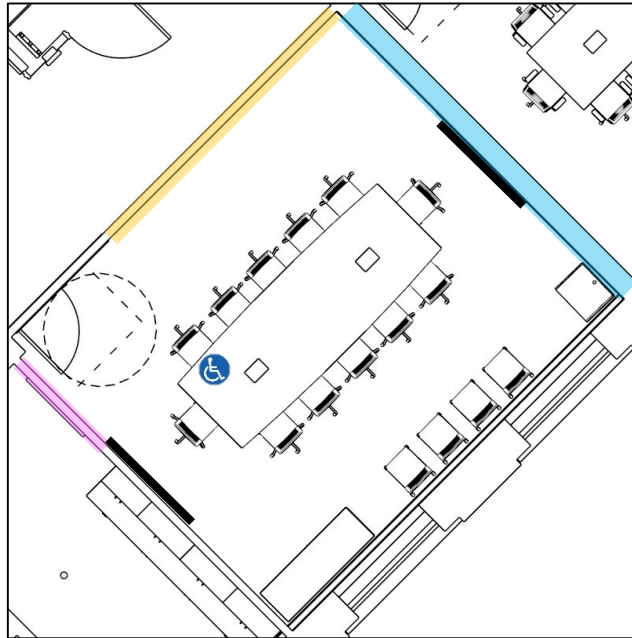

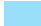
RUTHVEN-4120 (Table 12) (Capacity 16)



-  Acoustic Panels
-  Marker Board
-  Coat Hooks
-  Wheelchair Accessible







View from the Northwest Wall

**Conference chairs will be ordered with fixed arms*

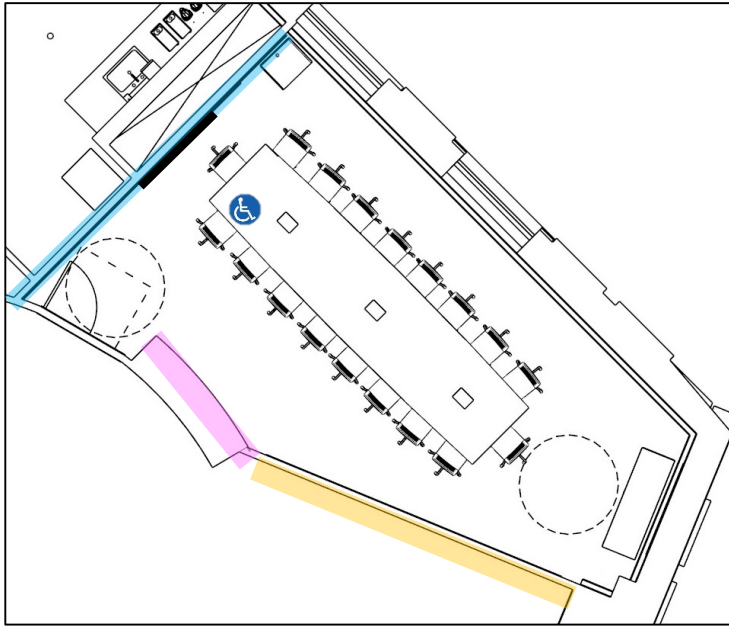

RUTHVEN-4140 (Table 18) (Capacity 18)



-  Acoustic Panels
-  Marker Board
-  Coat Hooks
-  Wheelchair Accessible



View from the Northwest Wall

**Conference chairs will be ordered with fixed arms*



RUTHVEN-4180 (Table 16) (Capacity 16) (No AV)

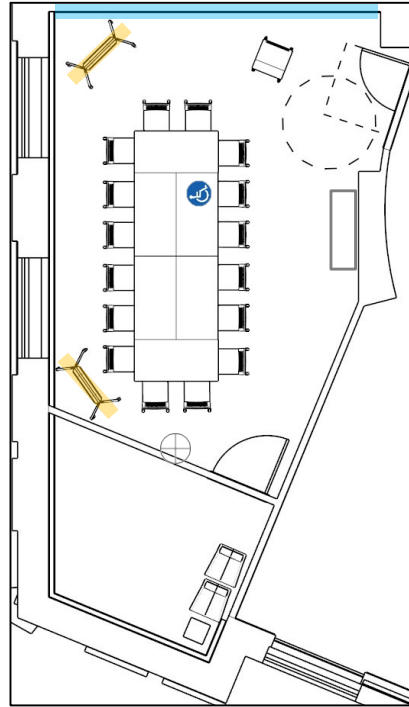

- Acoustic Panels
- Marker Board
- Coat Hooks
- Wheelchair Accessible



View from the Northwest Wall

Note: Filming Room

This room has no installed AV. A portable AV cart is available upon request, if arranged in advance with IT. However, depending on a given day's activities in the building, the cart may not always be available.

RUTHVEN-4180 (Alternate Layouts)

Video Taping – email BAS morning of event(PO-BldgAutoSys@umich.edu) to “Close Rth RM 4180 VAV Damper, heating and cooling valves to reduce the noise impact on the video reording from _____ to _____”

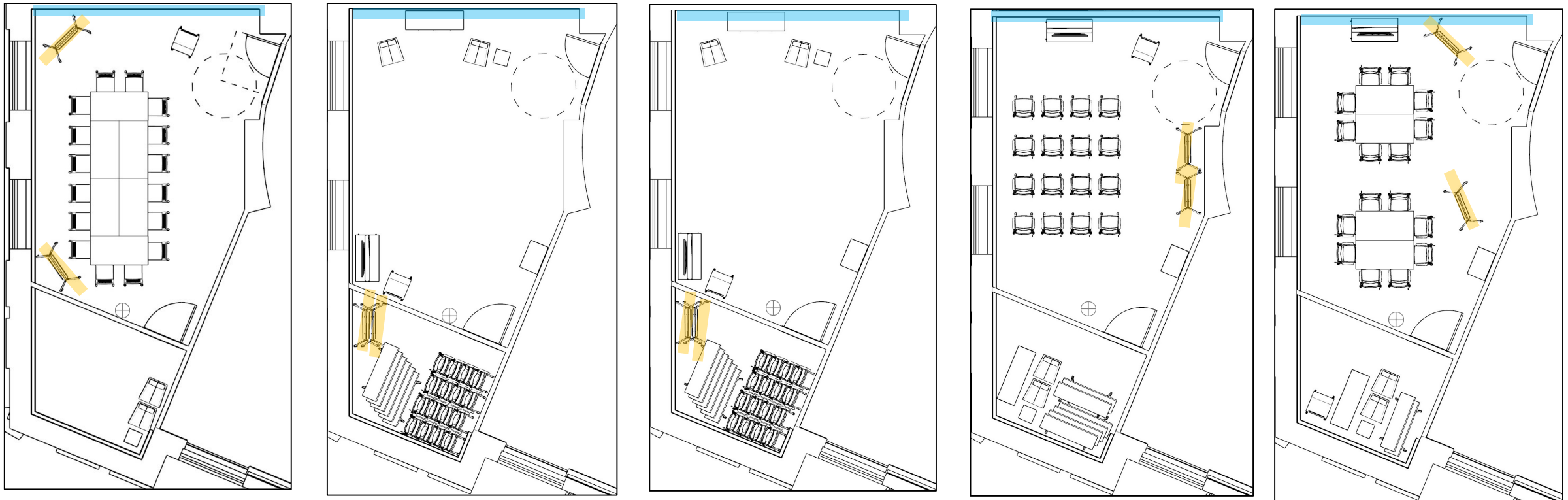

Alternate furniture layouts may be possible, if arranged in advance with building operations. However, furniture changes may not be possible, depending on a given day's activities.

RUTHVEN-4190 (Table 10) (Capacity 16)

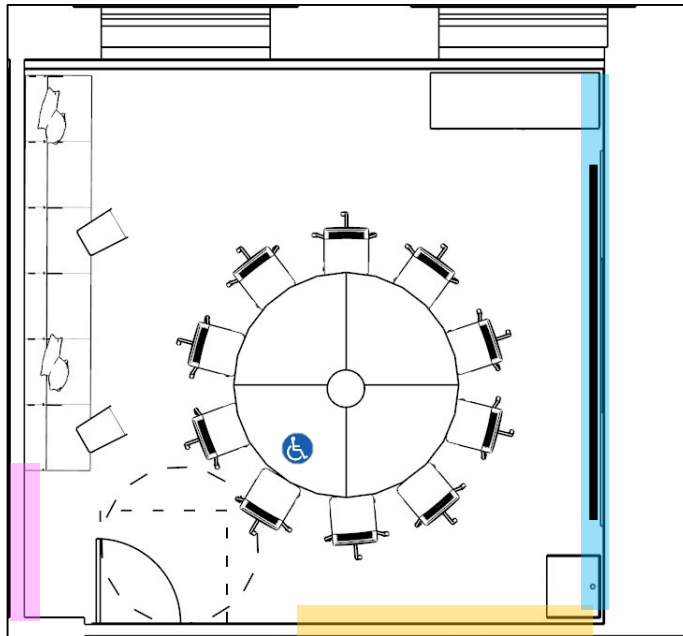

- Acoustic Panels
- Marker Board
- Coat Hooks
- Wheelchair Accessible



View from the South Wall

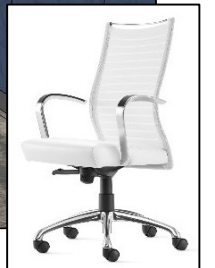

*Conference chairs will be ordered with fixed arms

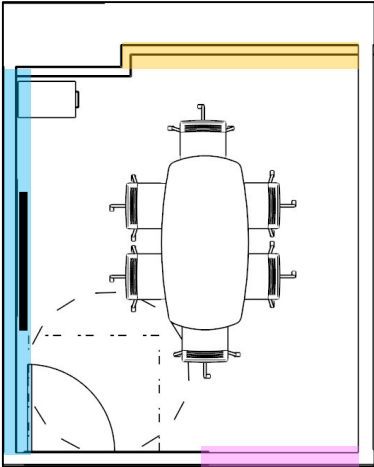

Furniture can be raised and lowered to allow for meetings at different heights.

RUTHVEN-4324 (Table 6) (Capacity 6)



-  Acoustic Panels
-  Marker Board
-  Coat Hooks
-  Wheelchair Accessible



View from the South Wall

*Conference chairs will be ordered with fixed arms



RUTHVEN-4394 (Table 8) (Capacity 8)

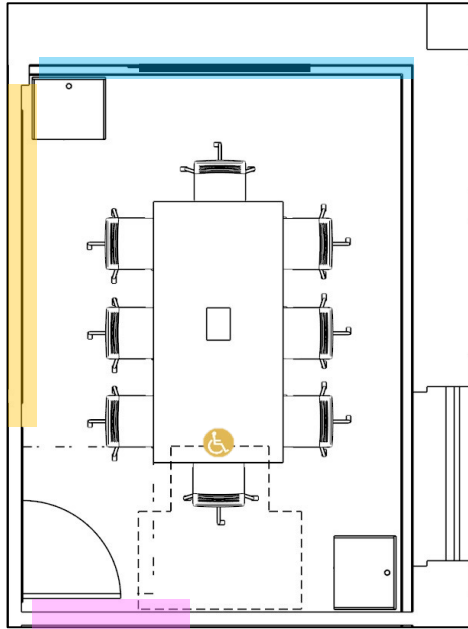

- Acoustic Panels
- Marker Board
- Coat Hooks
- Wheelchair Accessible when chairs moved out of the dashed circle / box



View from the South Wall

*Conference chairs will be ordered with fixed arms

